

Pos. Nr. Pos.no.	Beschreibung Description	Art.-Nr. Art.no.	Preisgruppe Price bracket
6	CZ-SKPL RH 810		
70385			
1	Inneneinrichtung Interior fittings	145427	17
2	E-Lokführer Loco-driver	126797	6
3	TS - Sitze Part set - Seats	145428	9
4	Rahmendeckel Frame cover	145429	8
5	Leitungen Lines	145430	6
6	Gehäuse kpl. Betr. nr. 810 054-7 Body complete Loco no. 810 054-7	145639	37
7	Tritt Li+Re Treadle L+R	145432	6
8	Spiegel li + re Mirrors L + R	145640	5
9	Platine analog PLUX-16 PCB analog	145149	18
10	Platine Innenbel. PCB interior lights	145150	18
11	Brückenstecker TVS PLUX-16 Jumper	133241	10
12	Motor KM Schwungm.+2 Kardansch. Motor with flywheel+2 cardan reception	145151	17
13	Kardanschale Cardan reception	145383	4
14	M-Kontaktfeder D=2,3 L=9,9 mm Contact spring	116812	3
15	TS - Fenster Part set - Windows	145386	18
16	Lichtnagel Light pin	145155	3
17	Scheibenwischer Li.+Re. Wipers L+R	145387	6
18	TS - Griffe Part set - Handles	145641	11
19	TS - Lichtnagel Part set - Light pin	145173	6
20	Kardanwelle L=20 mm Cardan shaft	100260	4
21	SK - Schraube M 1,6x4 mm SK - Screw	115161	3
Sound			
22	Platine Onboarddecoder MW PCB	145170	42
23	Lautsprecher Loudspeaker	129524	13

Änderungen in Konstruktion und Ausführung vorbehalten
We reserve the right to change the construction and specification

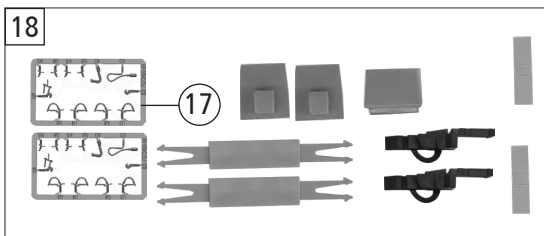
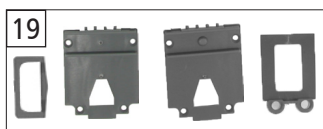
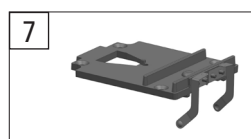
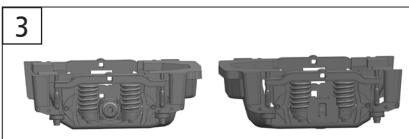
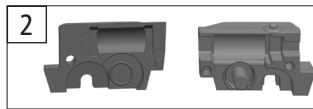
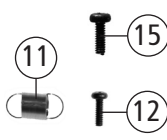
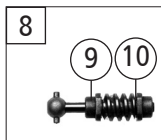
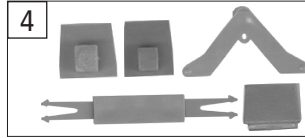
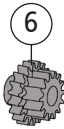
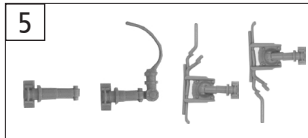
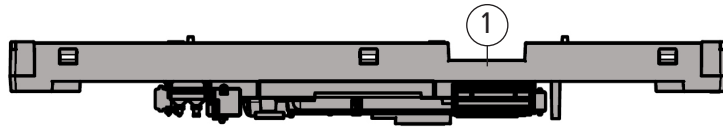

Pos. Nr. Pos.no.	Beschreibung Description	Art.-Nr. Art.no.	Preisgruppe Price bracket
1	Grundrahmen Base frame	145426	18
2	Getriebesatz 2tlg. Gear set 2 parts	145137	10
3	DG-Blende 1+2 Bogie frame	145431	10
4	TS - Deichsel Part set - Drawbar	145635	6
5	TS - Zylinder Part set - Cilinder	145636	7
6	Schneckenzahnrad Z=19re./14ge. Wormgear	86416	4
7	Radkontakt Li.+Re. Wheel contact L+R	145147	11
8	Schneckensatz Worm gear set	145148	13
9	Lager f. Schneckenachse Worm gear axle housing	89749	6
10	Beilagscheibe 2,1x4 / 0,2 mm Washer	86108	3
11	Zugfeder D=2,5 L=2,7/5,8 mm Draw spring	86208	3
12	SK - Schraube M 1,6x7 mm SK - Screw	116493	3
13	Standardkupplung Standard coupling	89246	6
14	Radsatz m.Zahnr. o.Haftr. Wheelset w.gearwh. w/o traction tyre	145638	11
15	GF - Schraube M 1,6x4 mm GF - Screw	114850	3
16	Puffer Buffer	145642	4
17	TS-Bremsschläuche und Zughaken Part set brake tubes & coupling hooks	139832	7
18	Zurüstbeutel Bag of accesories	145614	12
19	TS - Abdeckungen Part set - Covers	145637	7